

Capacity of rams is calculated assuming a free flowing load, a minimum tipping angle of 50° and includes body weight.

For specific capacities against known operating conditions contact PZB.

Maximum lifting capacity calculated at 170 Bar.

\* Measurement includes 20mm pull out required for mounting

**Please note:** When replacing a cylinder in a twin underbody application - the cylinders must be of the same batch date, due to modifications made to design over time.

## "L" SERIES UNDERBODY HOISTS

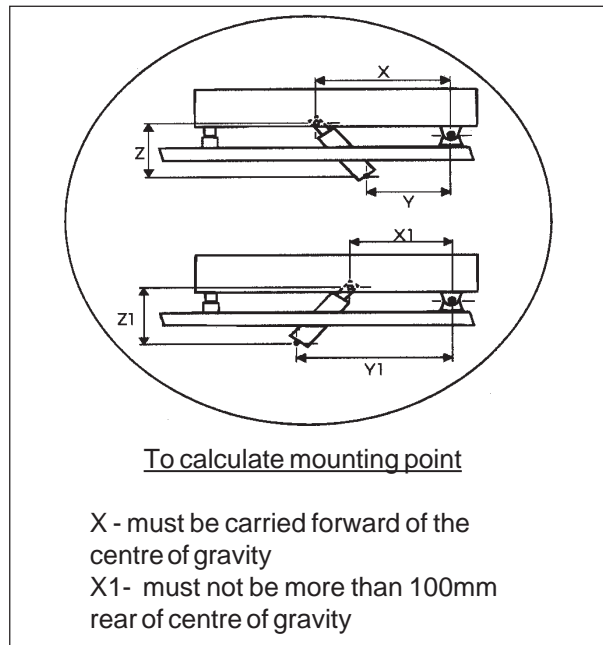

Type	Lift (mm)	No. Stag	Lift Capacity 50° tip		Ideal mounting pivot (mm)						* Closed Height (mm)	Mount SUP	Wt. Kg	Cap. Lt	Stage Diameter (mm)			
			Nom. ton.	Max. ton.	X	Y	Z	X1	Y1	Z1					61	76	91	107
3522F	600	2	3	5	1063	683	220	744	1124	220	438	45	22	2.3	●	●		
3524F	800	2			1390	923	270	1017	1483	270	538	45	28	3	●	●		
3545F	1200	4	7	12	1821	1434	224	1489	1867	224	447	45	36	7	●	●	●	●
3546F	1300	4			1963	1554	236	1611	2020	236	472	45	39	7.5	●	●	●	●
3547F	1500	4			2249	1796	261	1857	2309	261	527	45	43	8.8	●	●	●	●
3548F	1700	4			2538	2039	289	2103	2602	289	577	45	46.8	10	●	●	●	●

"L" SERIES UNDERBODY HOISTS

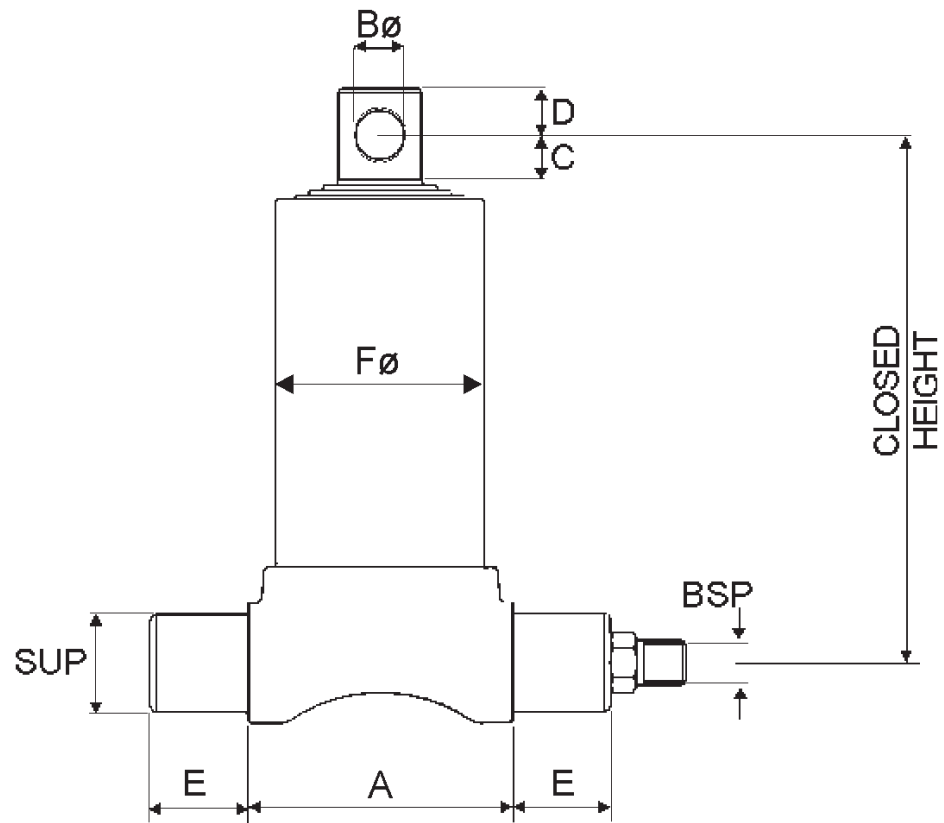

Dimensions of Rams (mm)									
Type	A	B	C	D	E	F	*CLOSED HEIGHT	BSP	Seal Kit
3522F	115	31	32	30	45	95	438	½"	SKCY002
3524F	115	31	32	30	45	95	538	½"	SKCY002
3545F	150	31	32	30	45	124	447	½"	SKCY004
3546F	150	31	32	30	45	124	472	½"	SKCY004
3547F	150	31	32	30	45	124	527	½"	SKCY004
3548F	150	31	32	30	45	124	577	½"	SKCY004